

**Unit 50
 'Park Breeze'
 61 North Street
 Southport**

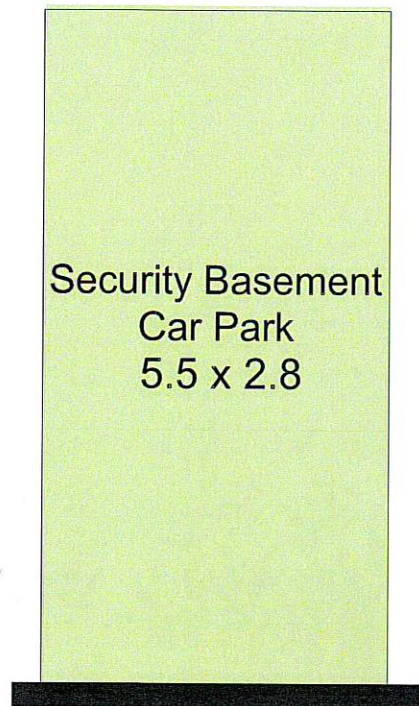
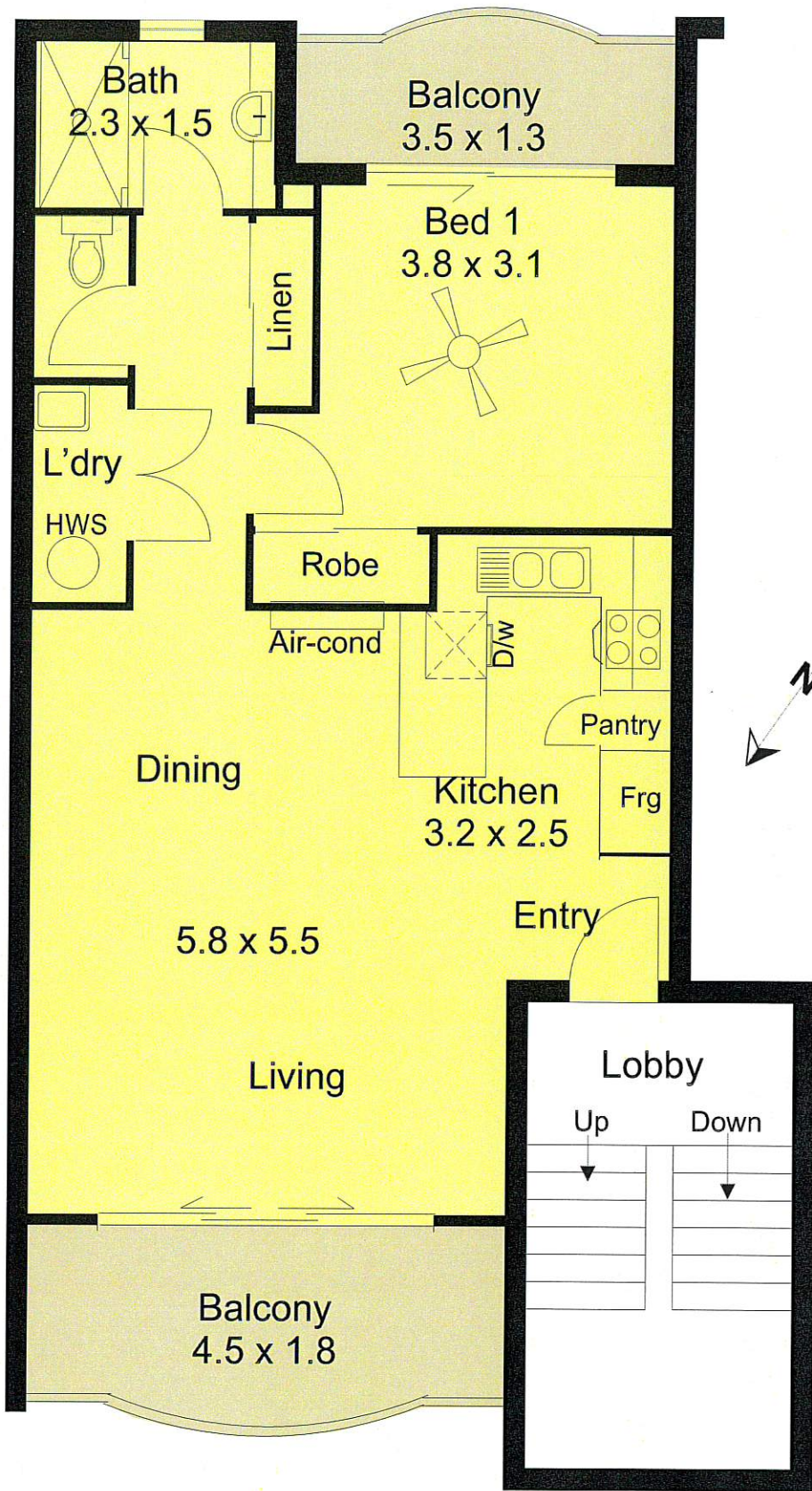

Areas	
Living	60 sq m
Balconies	12 sq m
Carpark	16 sq m
Total	88 sq m

Note While every endeavor has been made to verify the correct detail in this brochure, neither the Agent nor Seller or contracted illustrator accept liability for any error or omission. Prospective Buyers should make their own enquiries and form their own judgement on this property.