

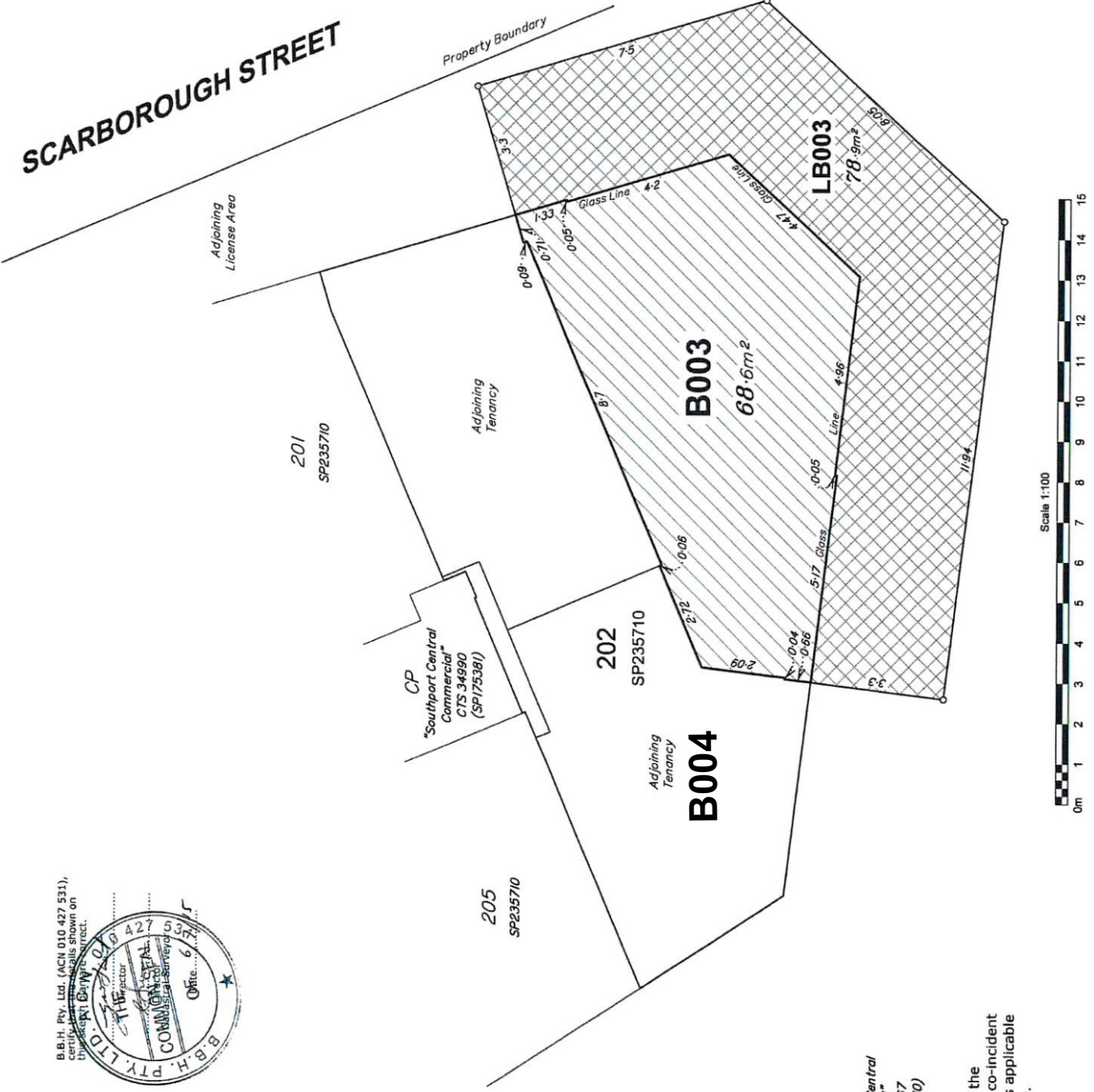

**SCARBOROUGH STREET**



- NOTES:**
1. Drawn to Scale on A3 sheet in accordance with the Registrar of Titles Directions for the preparation of building Format Lots under the Land Title Act 1994.
  2. Adjoining tenancies shown have been compiled from other sources and are diagrammatic only. Elements, distances shown are indicative only unless noted otherwise.
  3. Meridian of SP235710
  4. Hatch Denotes Lease Area
  5. Hatch Denotes License Area
  6. Denotes Screw in Title

Issue	Revision	In	Date
B	1	ARW	6/07/2015
A	1	MJR	05/04/2015

File:  
**Plan of Lease Area "B003" & License Area "LB003"**  
 Being part of Lot 202 in Level A (Ground Floor) on SP235710  
 "Southport Central Retail T1" CTS 41767

Client:	SPC
Locality:	SOUTHPORT
Local Gov:	GCCC
Prepared By:	MJR
Surveyed By:	ARW
Approved:	ARW
Date Created:	05/04/2015
Scale:	1:100
Comp File:	12075_202_Lease Calc_150403.dwg
Plan No:	12075_013_LEA-B

CP  
 "Southport Central Retail T1"  
 CTS 41767  
 (SP235710)

NOTE: Lease boundaries are the centre-line of wall and co-incident with BFP boundaries as applicable unless noted otherwise.